



## Holcroft Road

Harpenden, AL5 5BG

Immaculately presented family home, refurbished throughout to a high standard by our clients to create a large open plan kitchen/dining and family room. Well proportioned rooms, featuring a ground floor shower room with scope for further extension to the side and/or loft conversion (STPP). Added benefit of a detached garage with off street parking and a 100ft southerly aspect garden. Well placed for excellent schooling and close to beautiful open countryside.

**Guide price £650,000**

# Holcroft Road

## Harpenden, AL5 5BG



- Beautifully presented family home of over 1230 sq ft
- Detached Garage
- Well placed for excellent schools
- Spacious living area
- Off-street parking
- Easy access to open countryside
- Scope for side extension and/or loft conversion (STPP)
- 100 ft southerly aspect garden
- Council Tax Band E

### Porch

### Entrance Hall

### Living Room

15'10" x 9'10" (4.85m x 3.02m)

### Family Room

8'9" x 11'5" (2.67m x 3.49m)

### Kitchen/Dining Room

23'11" x 10'8" (7.31m x 3.26m)

### Utility Room

8'7" x 4'9" (2.63m x 1.47m)

### Shower Room

### Bedroom One

12'11" x 10'10" (3.95m x 3.32m)

### Bedroom Two

16'2" x 9'10" (4.94m x 3.02m)

### Bedroom Three

8'11" x 7'5" (2.73m x 2.28m)

### Bathroom

### Garage

15'10" x 8'0" (4.85m x 2.44m)

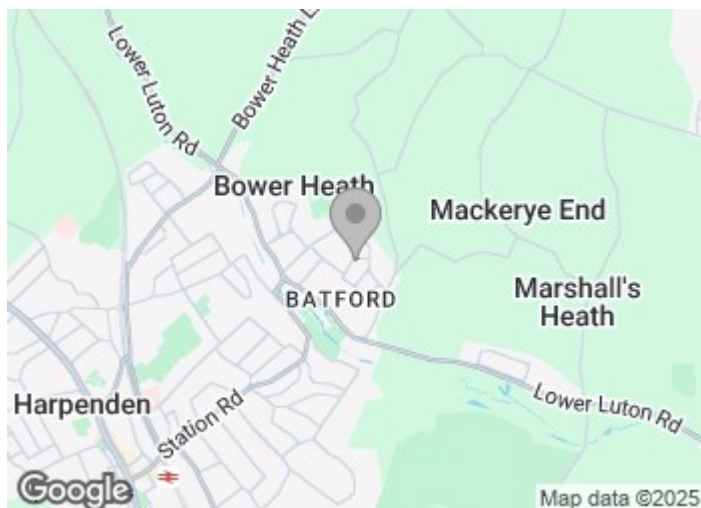





Floor Plan

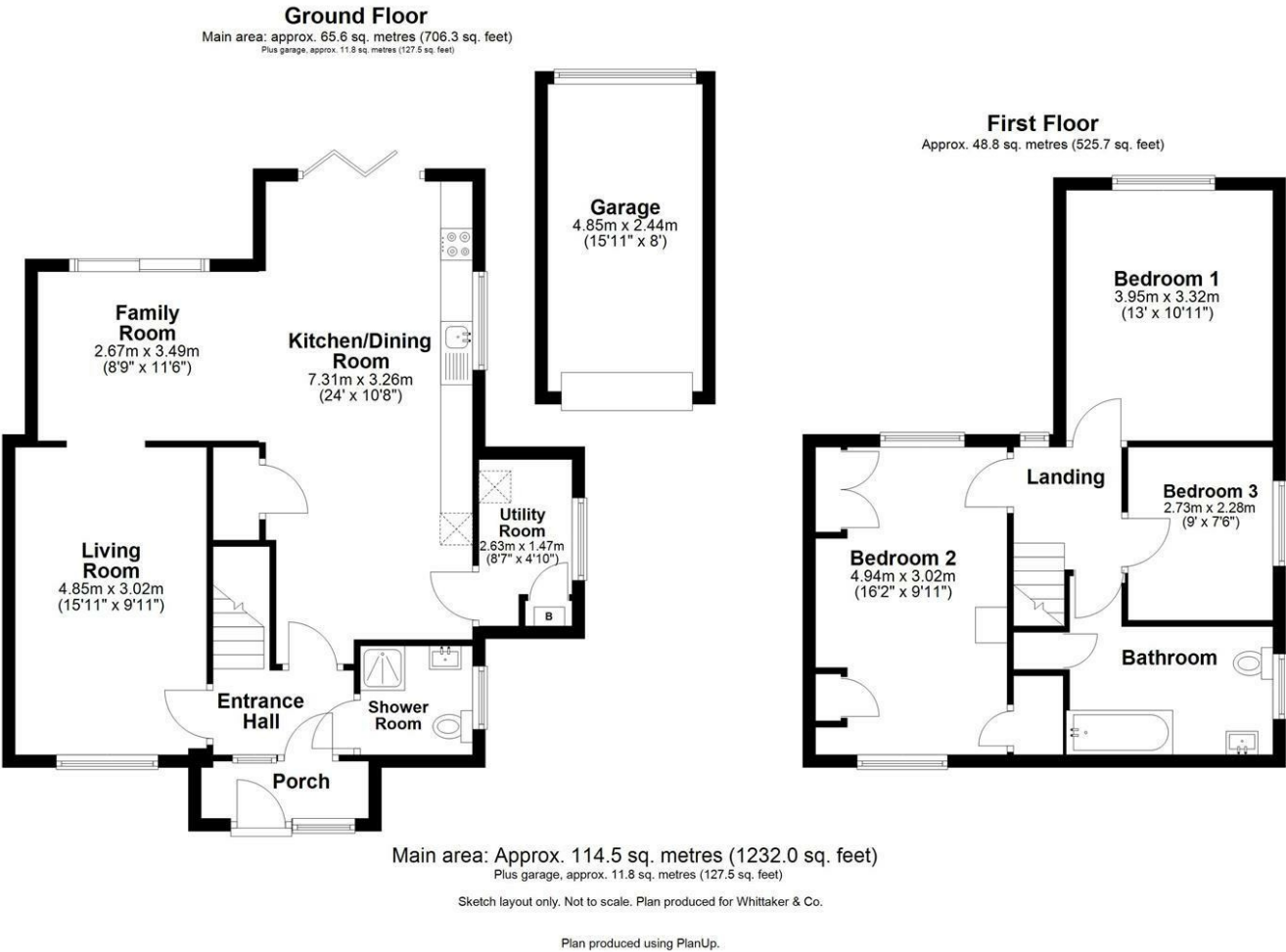

These particulars, whilst believed to be accurate are set out as a general outline only for guidance and do not constitute any part of an offer or contract. Intending purchasers should not rely on them as statements of representation of fact, but must satisfy themselves by inspection or otherwise as to their accuracy. No person in this firms employment has the authority to make or give any representation or warranty in respect of the property.

